



Connectors

BNC Connector



**BC
BNC**

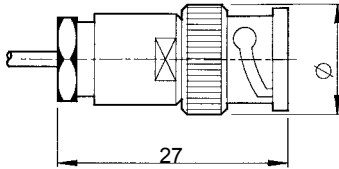

**L5
Connector for A/25
accelerometer**

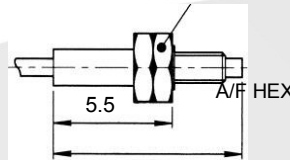

Case material : 303 S31
Max. temp. : -55/+168°C

**L8
Connector for A/28
accelerometer**

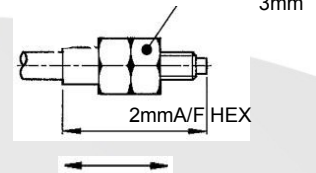

Case material : 303 S31
Max. temp. : -55/+168°C

**Epoxy Filled
Connector**



**PI
Epoxy filled pot core for 1.5mm
hardline cable flying leads**

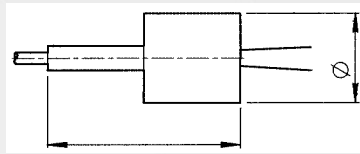

Case material : 303 S31
Max. temp. : -55/+80°C

**P2
Epoxy filled pot core for 2.5mm
hardline cable flying leads**

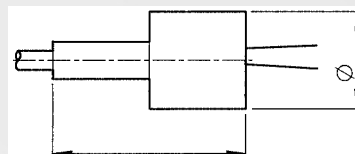

Case material : 303 S31
Max. temp. : -55/+80°C

**P3
Epoxy filled pot core for 3mm
hardline cable flying leads**

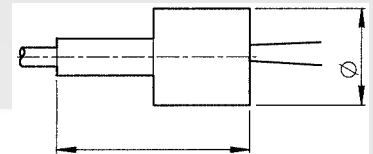

Case material : 303 S31
Max. temp. : -55/+80°C

**2 pole UNS
Connector**



**G2
Glass sealed Microdot
plug low noise cable**

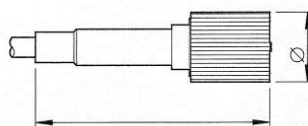

Case material : 303 S31
Max. temp. : -55/+250°C

**7S
2 pole 7/16" UNS free socket**

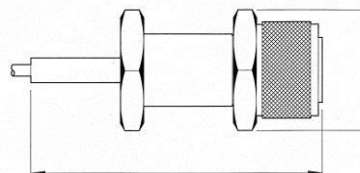

Case material : 303 S31
Max. temp. : -55/+400°C

**7P
2 pole 7/16" UNS free plug**

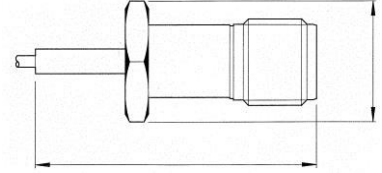

Case material : 303 S31
Max. temp. : -55/+400°C

TNC Connector



**TC
TNC**

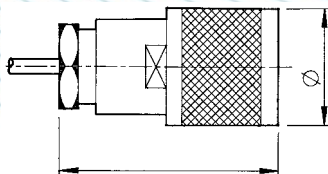

Case material : nickel plated

**TS
DJB TNC**

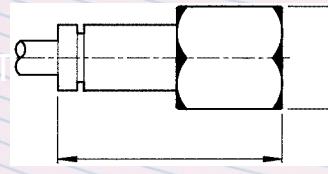

Case material : 303 S31
Max. temp. : -55/+155°C

**TN
DJB TNC**

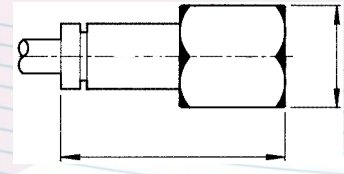

Case material : nitronic
Max. temp. : -55/+155°C



Connectors

All dimensions are approximate in mm
Note : max @ min temp.°C are based on P.T.F.E. cables, if P.V.C. cable is used, range will be

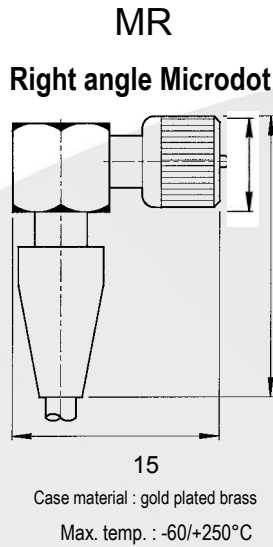
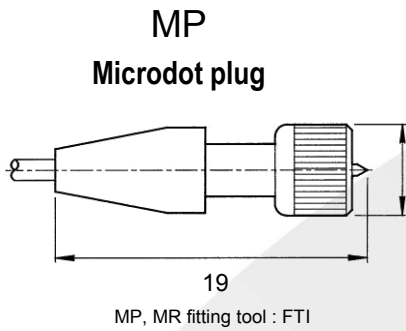

9.1



UNF
Connector

Microdot
Connector

